



Chest Harness Interface Bracket Assembly

for **Matrix PB (CHIPB)** and
Matrix Elite (CHIEB) Backs

Installation & Set-Up Manual

i **DEALER:** This manual contains important Safety, Installation and Set-up information specific to the Matrix Chest Harness Interface Bracket Assembly. This Manual **MUST** be given to the user of the product.

BEFORE using this product, please read through the instructions carefully and save for future reference.

Safety Symbols:

Installing your Matrix Seating Series product safely depends upon your diligence in following the warnings, cautions and information provided in this Installation Manual.

The symbols below are used throughout all Motion Concepts' manuals to identify warnings, cautions and important notes. It is very important for you to read and understand them completely.



WARNING!

This symbol warns you of danger!

- Always follow these instructions to avoid injury to the user or damage to the product!



IMPORTANT!

- Important information to remember when operating your Motion Concepts power positioning system



NOTE:

- This symbol identifies general information which is intended to simplify working with your product and/or which refers to special functions or important instructions.



Requirements:

- This symbol identifies a list of various tools, components and items which you will need in order to carry out certain work.



READ WELL BEFORE OPERATION!

- This symbol advises you to read information carefully.

Chest Harness Interface Brackets for the Matrix PB & Matrix Elite

SAFETY WARNINGS:



WARNING!

The Matrix-PB and Matrix Elite Chest (Support) Harness Interface Brackets were intended for use with OEM support harnesses such as the Invacare Pro-tech series or the Body Point harness series.

- Always ensure all harness fittings and hardware is compatible with the support harness mounting brackets provided.
- DO NOT modify the support harness mounting brackets; Unauthorized modifications to the mounting brackets may result in personal injury and will compromise the limited warranty.



WARNING!

Support Harnesses and Positioning Belts are **not** designed to provide proper restraint during motor vehicle transport and should never be utilized as a Safety Restraint.

- DO NOT sit in your wheelchair while it is in a moving vehicle. When travelling in a motor vehicle you must be properly secured in a motor vehicle seat with approved safety belts securely fastened.



WARNING!

The Matrix-PB and Matrix Elite Chest Harness Mounting Bracket Assemblies have NOT been crash tested and are NOT approved for use as part of a vehicle safety restraint during transport.

- When travelling in a motor vehicle, the user must be properly secured in a motor vehicle seat with approved safety belts securely fastened.



WARNING!

Please check your support harness weekly to ensure that it is still in good working condition; to ensure it has no damage or wear, and to ensure it is fixed properly to the wheelchair.

- If the support harness is fastened using a bolted connection, ensure that the connection has not loosened or come undone.
- Please be certain to read the service manual provided by the support harness manufacturer for more information about safety and maintenance of your support harness.



IMPORTANT!

Please be certain to read the **Support Harness User Manual** (*provided separately*) for important safety information and instructions regarding the proper set-up, installation and use of your support harness.

If you have any questions or concerns during the installation of the Chest Harness Interface Bracket Assembly please contact our Technical Service Department for assistance:

Canada: 800-680-4191

USA: 888-433-6818

1.0 CHEST HARNESS INTERFACE for the **Matrix Elite Back (CHIEB)**

1.1 CHIEB Installation Overview:

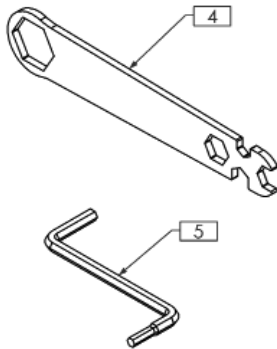
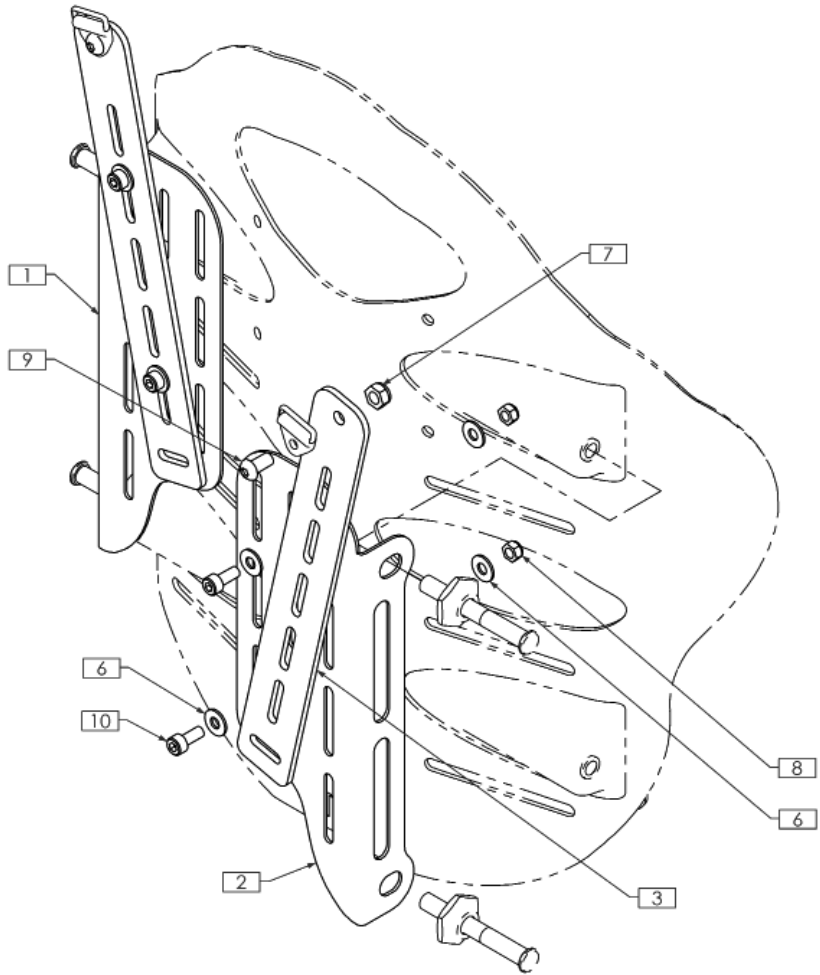
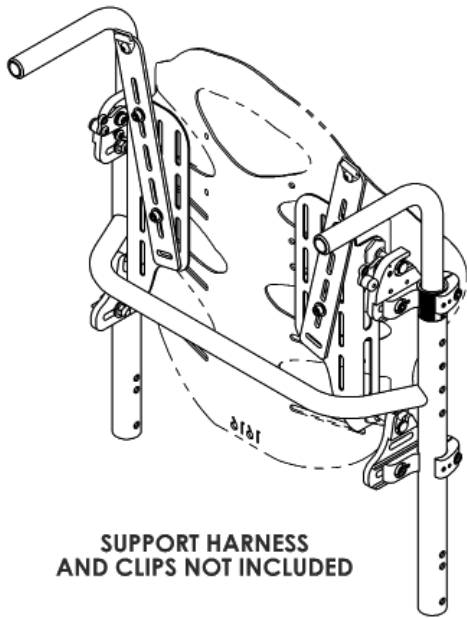

ITEM NO.	QTY.	PART NO.	DESCRIPTION
1	1	TRX7254	SUPPORT HARNESS MOUNTING BRACKET, LEFT
2	1	TRX7255	SUPPORT HARNESS MOUNTING BRACKET, RIGHT
3	2	TRX7256	SUPPORT HARNESS EXTENSION BRACKET
4	1	TRX6546	MULTI-WRENCH, UNIVERSAL
5	1	TRX6809	MULTI-METRIC HEX KEY, 4mm/5mm
6	8	TRH0114	3/16" FLAT WASHER, SAE, BZ
7	2	TRH0258	M6 NYLOC NUT, BZ
8	4	TRH0697	M5 NYLOC NUT, BZ
9	2	TRH0700	M6-1.0 x 12mm BUTTON SOCKET CAP, ALLOY STEEL, BZ
10	4	TRH0741	M5-0.8 X 12mm SOCKET HEAD CAP, ALLOY STEEL, BZ

1.0 CHEST HARNESS INTERFACE for the Matrix Elite Back (CHIEB)



Please read through the following installation instructions **before** proceeding with the Chest Harness Interface Bracket installation

1.2 Chest Harness Interface Bracket Installation Instructions (CHIEB):

1. If applicable, remove the existing mounting pins (x4) and flange nuts (x4) from the Matrix Elite Back Shell (retain hardware).

NOTE: For ease of installation, we recommend installing the extension bracket onto the mounting plate prior to securing the entire assembly onto the back shell.

2. Use the various mounting slots to achieve the desired angle & height of the extension bracket, and loosely install the extension bracket onto the mounting plate using the hardware provided* (1). (Refer to **Figure 1** for some of the sample installation/adjustment options available for the extension bracket).

***note:** to help pre-determine the mounting position of the extension bracket, align the mounting plate with the back shell and position the extension bracket on the plate to determine which slots/mounting hardware locations will produce the desired position.

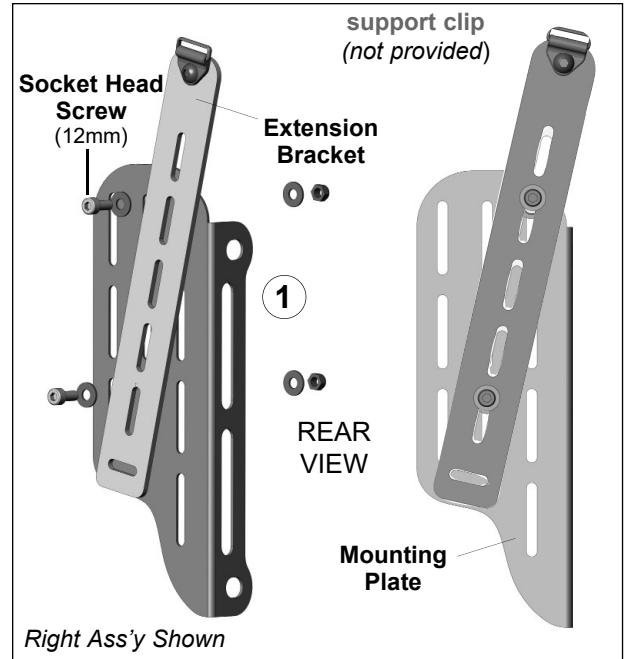
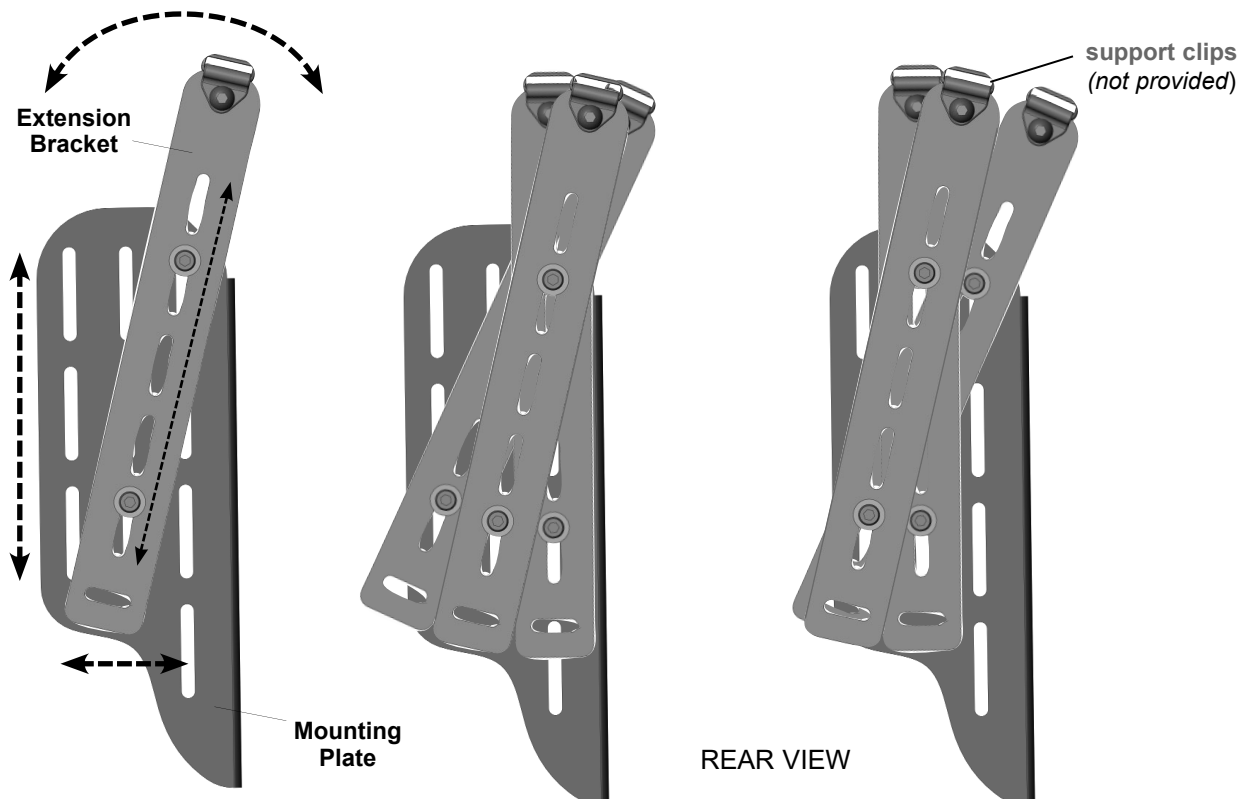

Figure 1. EXTENSION BRACKET ADJUSTMENT (Height, Width & Angle Adjustment)



Right Extension Bracket Assembly Shown

1.0 CHEST HARNESS INTERFACE for the **Matrx Elite Back (CHIEB)**

1.2 Chest Harness Interface Bracket Installation Instructions (CHIEB)... (cont'd):

3. Working on one side of the back shell, align the mounting holes in the mounting bracket with the pin hole locations on the elite back shell (1).
 4. Install/secure the mounting bracket using the mounting pins/flange nuts provided with the back shell (2).
(**Note:** please refer to your *Matrx Elite User Manual* for instructions on setting the proper mounting pin depth).
- i IMPORTANT!** Once the pin depth has been properly adjusted, ensure the flange nuts are fully tightened against the mounting bracket.
5. Repeat steps 3 and 4 for the opposite side of the back shell.

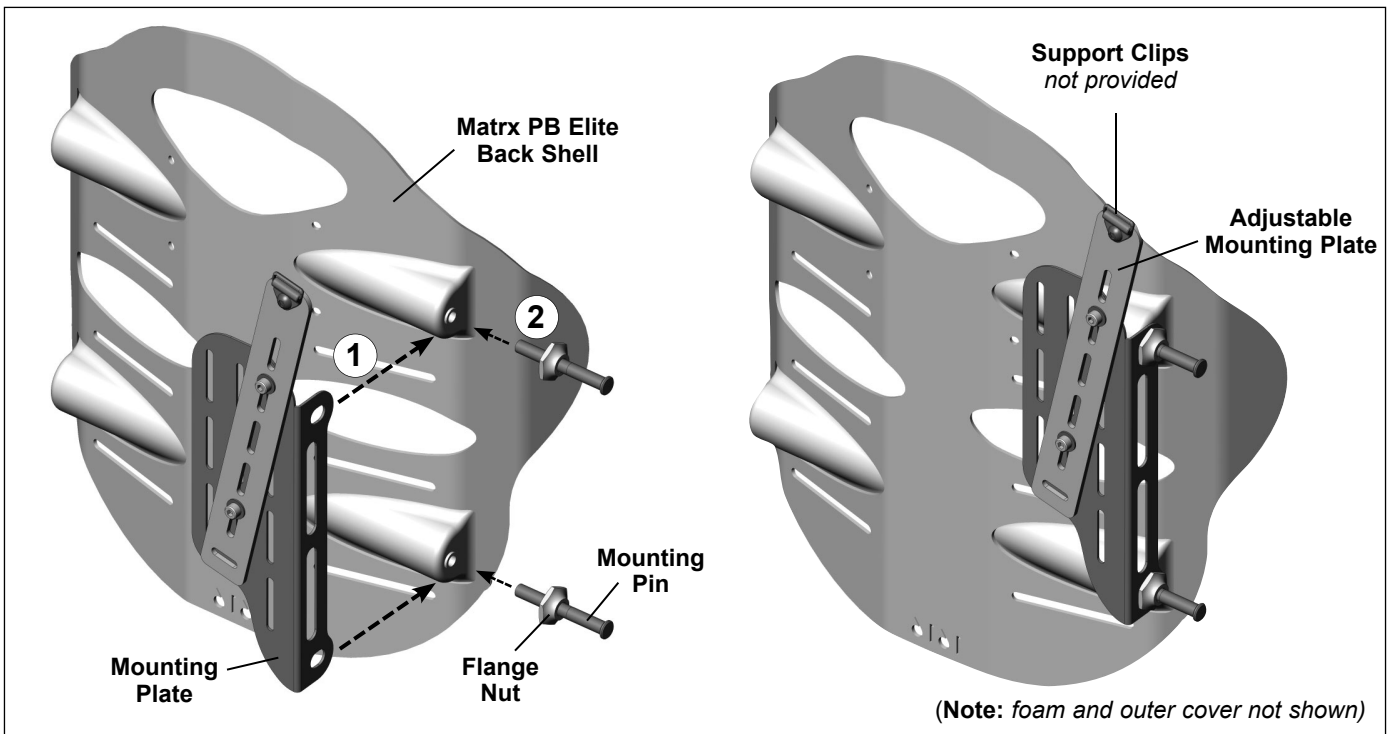

6. Install the support clips (*included separately with your support harness*) onto the extension bracket using the 12mm button head screws provided.

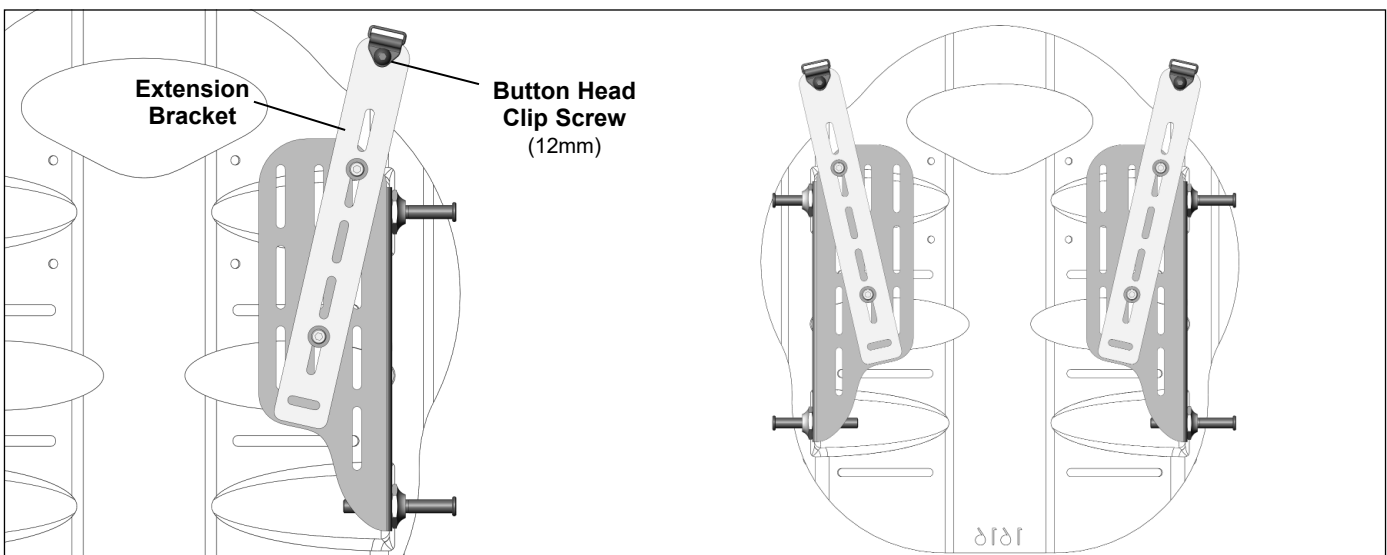

1.0 CHEST HARNESS INTERFACE for the Matrix Elite Back (CHIEB)

- 7 Make any final adjustments to the extension bracket position (height/angle) and fully tighten hardware.
- 8 Verify that all remaining mounting/installation hardware is secured.
- 9 With the Chest Harness Interface Assembly fully installed, please refer to your **OEM Support Harness User Manual** (*provided separately*) for important safety information and instructions regarding the proper set-up and installation of your support harness.

If you have any questions or concerns during the installation of the Chest Harness Interface Bracket Assembly please contact our Technical Service Department for assistance:

Canada: 800-680-4191

USA: 888-433-6818

2.0 CHEST HARNESS INTERFACE for the Matrx PB Back (CHIPB)

2.1 Installation Overview (Matrx PB Backs):

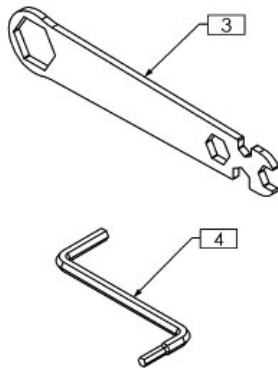
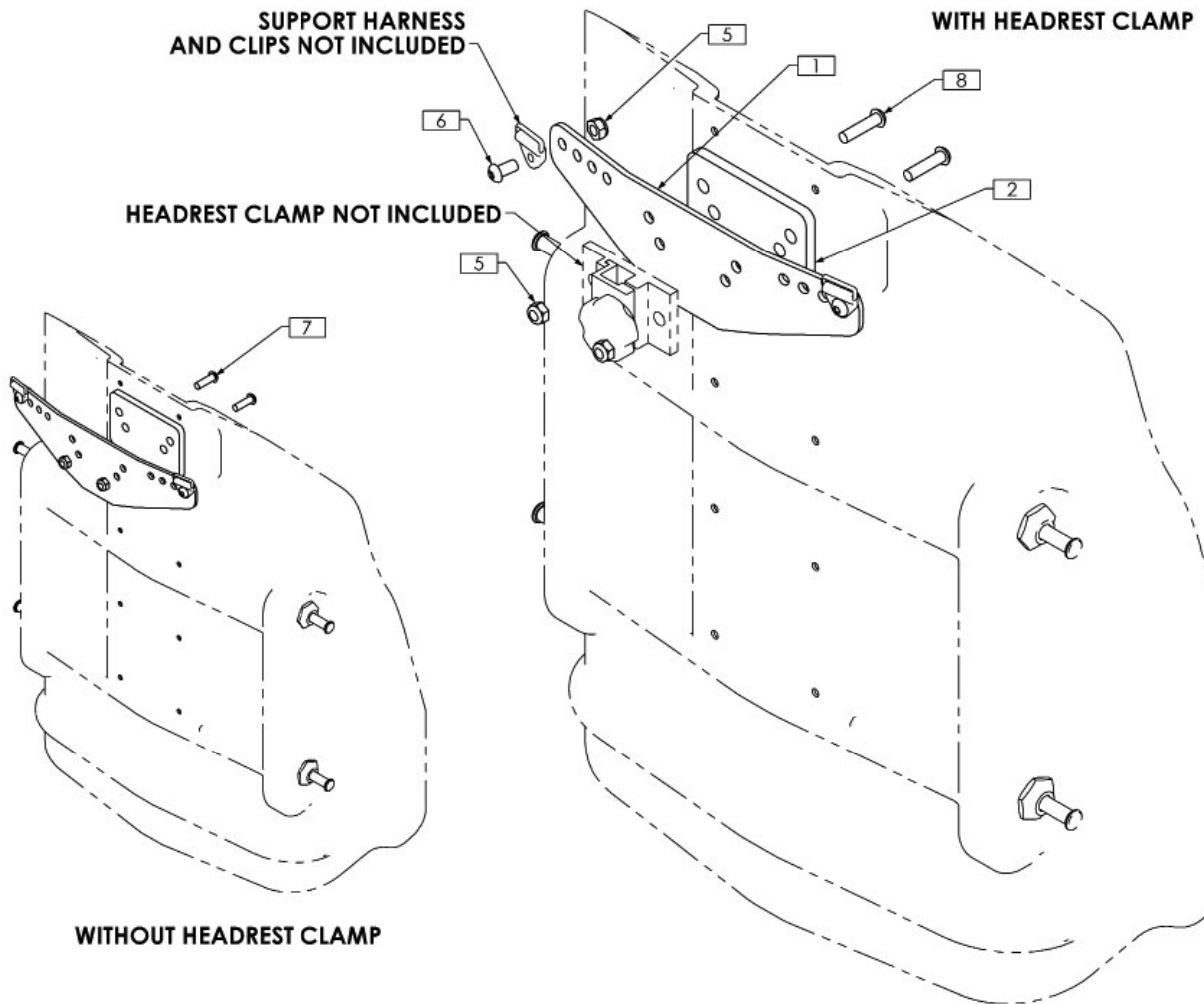

ITEM NO.	QTY.	PART NO.	DESCRIPTION
1	1	TRX7257	SUPPORT HARNESS MOUNTING BRACKET
2	1	TRX7586	SHIM
3	1	TRX6546	MULTI-WRENCH, UNIVERSAL
4	1	TRX6809	MULTI-METRIC HEX KEY, 4mm/5mm
5	4	TRH0258	M6 NYLOC NUT, BZ
6	2	TRH0700	M6-1.0 x 12mm BUTTON SOCKET CAP, ALLOY STEEL, BZ
7	2	TRH0757	M6-1.0 x 20mm BUTTON SOCKET CAP, ALLOY STEEL, BZ
8	2	TRH0774	M6-1.0 x 25mm BUTTON SOCKET CAP, ALLOY STEEL, BZ

2.0 CHEST HARNESS INTERFACE for the Matrx PB Back (CHIPB)



Please read through the following installation instructions **before** proceeding with the Chest Harness Interface Bracket installation

2.2 Chest Harness Interface Bracket Installation Instructions (CHIPB):

1. Unzip the outer cover along the top of the Matrx PB back, and peel/pull back the cover and foam to access the pre-drilled mounting holes in the back shell (*foam and outer cover not shown*). (**Note:** If applicable, remove existing headrest mounting plate and hardware from the back shell).
2. Align the shim plate and harness support bracket with the pre-drilled headrest mounting holes on the back shell as indicated below (1).
3. Using the hardware provided, install the mounting screws* from the inside of the back shell so that they protrude through the shim plate and harness support bracket.
(***Note:** a set of long (25mm) and short (20mm) mounting screws is provided in each hardware kit. The short screws allow the support harness bracket/shim to be installed directly onto the back shell; the long screws are intended for use when a headrest clamp (not provided) is installed- please **see WARNING! below**)



WARNING! When installing or re-installing a Headrest Clamp/Assembly onto a Matrx PB-Back, **always** ensure the long (25mm) mounting screws (*provided*) are used. **Always** ensure there is sufficient screw thread available to fully secure the nyloc nuts. Failure to ensure the headrest clamp and harness support bracket are properly installed may result in serious personal injury.

4. Secure the Chest Harness Interface Bracket (*and headrest clamp, if applicable*) onto the back shell using the appropriate hardware provided.
 5. Install support clips* (*included separately with the support harness*) using the 12mm clip screws provided.
- i** ***NOTE:** Support clips may be installed in 1 of 4 positions (widths) along the harness mounting bracket (refer to Figure 2.0). Prior to installing the support clips, please refer to your **OEM Support Harness User Manual** (provided separately) for important safety information and instructions regarding proper harness set-up.

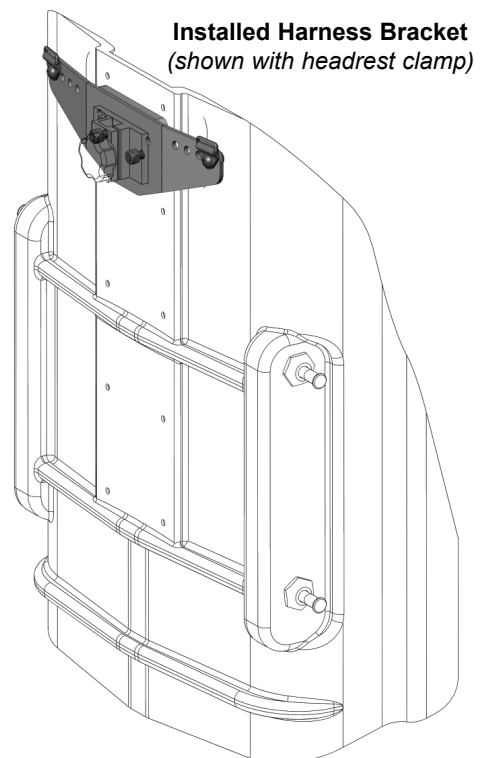
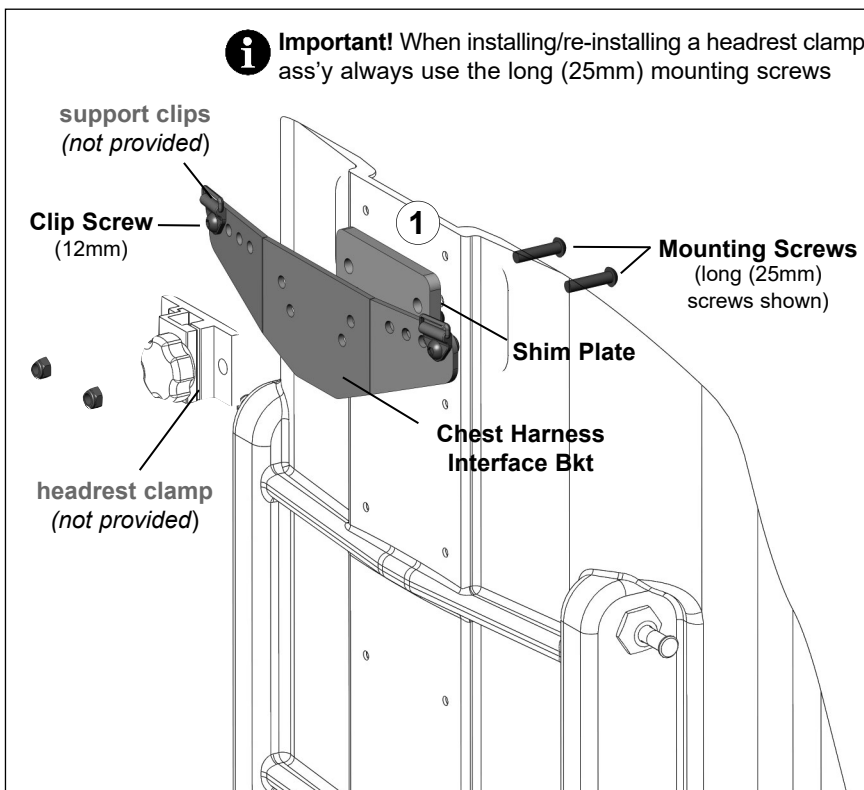

(Note: foam and outer cover not shown)

2.0 CHEST HARNESS INTERFACE for the **Matrx PB Back (CHIPB)**

2.2 Chest Harness Interface Bracket Installation Instructions (CHIPB): ...cont'd:

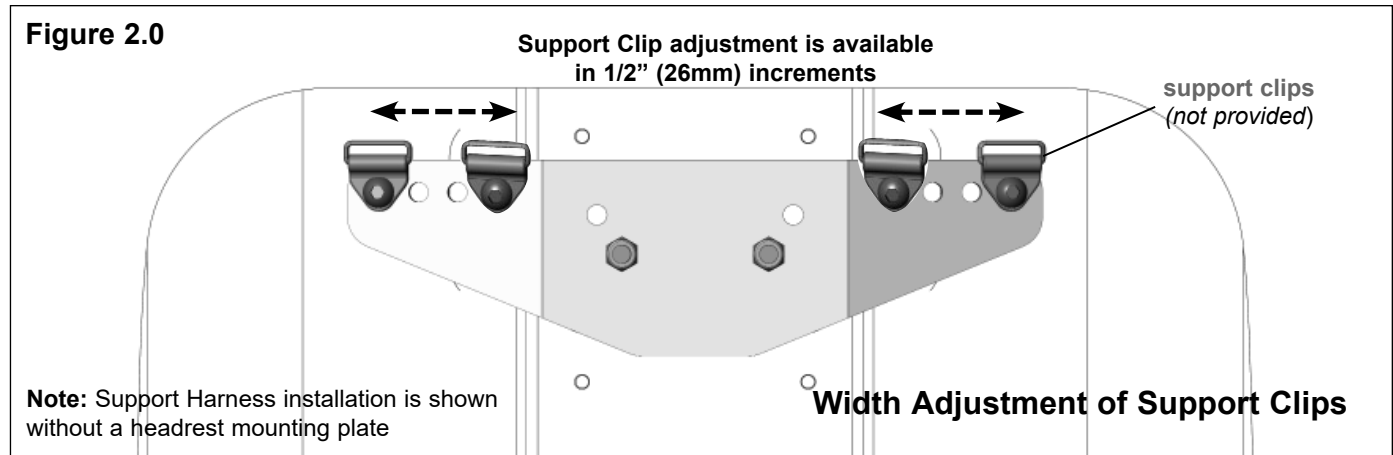

- 6 Verify that all mounting/installation hardware is fully secured.
- 7 Re-align the foam and cover along the top of the Matrx PB back shell and close up the zipper.
- 8 With the Chest Harness Interface Bracket Assembly fully installed, please refer to your **OEM Support Harness User Manual** (*provided separately*) for important safety information and instructions regarding the proper set-up and installation of your support harness.

If you have any questions or concerns during the installation of the Chest Harness Interface Bracket Assembly please contact our Technical Service Department for assistance:

Canada: 800-680-4191

USA: 888-433-6818

NOTES:

Contact Information
Informations de contact
Kontaktdata
Información de contacto
Informações de contacto

United Kingdom • Invacare Limited, Pencoed Technology Park, Pencoed, Bridgend CF35 5HZ •
Tel: (44) (0) 1656 776 222 •
Fax: (44) (0) 1656 776 220 • www.invacare.co.uk •
UK@invacare.com

Ireland • Invacare Ireland Ltd, Unit 5 Seatown Business Campus, Seatown Road, Swords, County Dublin-Ireland • Tel: (353) 1 810 7084 •
Fax: (353) 1 810 7085 • www.invacare.co.uk •
ireland@invacare.com

France • Invacare France Opération, Route de Saint Roch, 37230 Fondettes • Tel: (33) (0) 2 47 62 64 66 •
Fax: (33) (0) 2 47 42 12 24 • www.invacare.fr •
contactfr@invacare.com

Belgium & Luxemburg • Invacare nv, Autobaan 22, B-8210 Loppem, Brügge • Tel: (32) (0) 50 83 10 10 •
Fax: (32) (0) 50 83 10 11 • www.invacare.be •
belgium@invacare.com

Switzerland • Invacare AG, Benkenstrasse 260, CH-4108 Witterswil • Tel: (41) (0) 61 487 70 80 •
Fax: (41) (0) 61 487 70 81 •
switzerland@invacare.com

Deutschland • Invacare GmbH, Alemannenstraße 10, D-88316 Isny • Tel: (49) (0) 75 62 7 00 0 •
Fax: (49) (0) 75 62 7 00 66 •
www.invacare-aquatec.de • info@invacare-aquatec.com

Eastern Europe, Middle East & Africa • Invacare European Distributor Organisation, Kleisestraße 49, D-32457 Porta Westfalica •
Tel: (49) (0) 57 31 754 540 • Fax: (49) (0) 57 31 754 541 •
www.invacare.eu.com • edo@invacare.com

Portugal • Invacare Lda, Rua Estrada Velha, 949, P-4465-784, Leça do Balio •
Tel.: (351) (0)225 1059 46/47 •
Fax: (351) (0)225 1057 39 •
portugal@invacare.com

Motion Concepts:

Canada • Motion Concepts, 84 Citation Drive, Unit 1, Concord, Ontario, L4K 3C1 •
Tel: (905) 695-0134 • Fax: (905) 695-0138 •
www.motionconcepts.com

USA • Motion Concepts, 700 Ensminger Rd., Suite 112, Tonawanda, New York 14150 •
Tel: (716) 447-0050 • Fax: (716) 447-0030 •
info@motionconcepts.com

Per informazioni
Kontaktoplysninger
Kontaktinformation
Yhteystiedot

Norge • Invacare AS, Grensesvingen 9, Postboks 6230, Etterstad, N-0603 Oslo • Tel: (47) (0) 22 57 95 00 •
Fax: (47) (0) 22 57 95 01 • norway@invacare.com •
island@invacare.com

Italia • Invacare Mecc San s.r.l., Via dei Pini 62, I-36016 Thiene (VI) • Tel: (39) 0445 38 00 59 •
Fax: (39) 0445 38 00 34 • www.invacare.it •
italia@invacare.com

España • Invacare SA, c/Areny s/n, Polígono Industrial de Celrà, E-17460 Celrà (Girona) •
Tel: (34) (0) 972 49 32 00 • Fax: (34) (0) 972 49 32 20 •
www.invacare.es • contactsp@invacare.com

Canada • Invacare Canada, Inc., 570 Matheson Blvd. E. Unit 8, Mississauga, Ontario, L4Z 4G4 •
Tel: (905) 890-8300 • Fax: (905) 890-5244 • www.invacare.ca

Danmark • Invacare A/S, Sdr. Ringvej 37, DK-2605 Brøndby • Tel: (45) (0) 36 90 00 00 •
Fax: (45) (0) 36 90 00 01 •
www.invacare.dk • denmark@invacare.com

Sverige & Suomi • Invacare AB, Box 66, S-163 91, Spånga SWEDEN • Tel: (46) (0) 8 761 7090 •
Fax: (46) (0) 8 761 8108 • www.invacare.se •
sweden@invacare.com

Nederland • Invacare BV, Celsiusstraat 46, NL-6716 BZ Ede • Tel: (31) (0)318 695 757 •
Fax: (31) (0)318 695 758 • www.invacare.nl • nederland@invacare.com •
csede@invacare.com

Österreich • Invacare Austria GmbH, Herzog Odilostrasse 101, A-5310 Mondsee, Austria •
Tel: (43) (0)6232 5 53 50 •
Fax: (43) (0)6232 5 53 54 •
www.invacare.at • info@invacare-austria.com

EC REP

Advena Ltd. Tower Business Center, 2nd Flr., Tower Street, Swatar, BKR 4013 Malta

matrx[®]
SEATING SERIES

